

2.1MEGAPIXEL HD-SDI 59.94FPS GENLOCK BROADCAST MINI BOX CAMERA

HDC-SD041G

• ACCESSORY (Option)

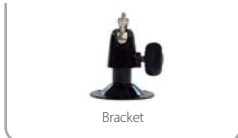

→ KEY FEATURES

- 1/3" 2.1Megapixel PANASONIC CMOS Image Sensor
- Full HD 1920x1080 (25p, 29.97p, 30p, 50p, 59.94p, 60p, 50i, 59.94i, 60i)
- HD 1280x720 (50p, 59.94p, 60p)
- HD-SDI, 3G-SDI, HDMI & Analog CVBS Video Out
- GENLOCK External SYNC Input/Output Support
- Megapixel C/CS Mount Lens
- DNR (Digital Noise Reduction)
- WDR (Wide Dynamic Range) : 1080p/30fps
- Min. Illumination of 0.01Lux
- Sens-up
- Auto White Balance
- Defog
- LSC (Lens Shading Compensation)
- ACE (Adaptive Contrast Enhancer)
- DIS (Digital Image Stabilizer)
- Motion Detection & Privacy Mask
- Digital Zoom
- Enable Reverse Display by Mirror & Flip
- Max. Transmission : 100m (5C-HFBS Cable Use)
- OSD Control

→ REAR

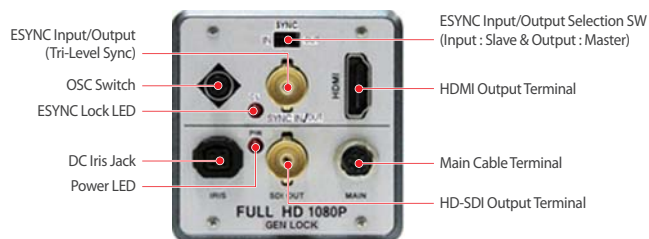

→ DIMENSIONS

Unit : mm

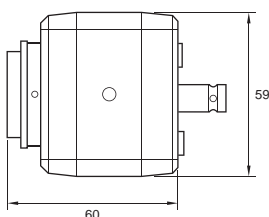

→ SPECIFICATIONS

HDC-SD041G	
Image Sensor	1/3" 2.1Megapixel PANASONIC CMOS Sensor
Total Pixels	2010(H) x 1108(V) / 2,227,080 (pixels)
Effective Pixels	1944(H) x 1092(V) / 2,122,848 (pixels)
Scanning System	Progressive
Sync System	Internal
Resolution	More than 1000TVL
Video Output	HD-SDI / 3G-SDI
	1920x1080 (25p, 29.97p, 30p, 50p, 59.94p, 60p, 50i, 59.94i, 60i)
	1280x720 (50p, 59.94p, 60p)
	HDMI 1.3
GENLOCK Support Format	Composite (1.0Vp-p, 75Ω) / NTSC, PAL
	Color Bar Signal
External SYNC Input	1920x1080 (25p, 29.97p, 30p, 50p, 59.94p, 60p)
	1080i Not Support
External SYNC Output	Slave Mode : Tri-Level Sync Input (1.0Vp-p, 75Ω)
S/N Ratio	Master Mode : Tri-Level Sync Output (1.0Vp-p, 75Ω)
Min. Illumination	More than 50dB (AGC Off)
Lens	0.1Lux (F1.2, 50IRE, AGC Max.) / DSS x4 : 0.01Lux
Electronic Shutter Speed	Megapixel C/CS Mount Lens
Sens-up	Auto / Manual (1/30(25) ~ 1/30,000sec.)
White Balance	x2 ~ x32
Back Light	Auto / AutoEXT / Preset / Manual (R-Gain, B-Gain)
WDR	Off / HLC / BLC / WDR
Day & Night	Off / Low / Middle / High
DNR	Auto / Color / B&W
LSC	Off / Low / Middle / High
Defog	Off / On
Digital Zoom	Off / On
Privacy Mask	x1 ~ x16
Motion Detection	Yes
Mirror / Flip	Yes
Camera ID	Off / On
Serial Port	Yes
ICR (Filter Change)	RS-232
Operating Temperature	Yes (Option)
Storage Temperature	-10°C ~ 50°C
Operating Humidity	-20°C ~ 70°C
Power Source	Under 90% Non-condensing
Power Consumption	DC 12V 1.0A
Dimension	360mA, 4.3W
Weight	59(W) x 59(H) x 60(D)mm
	280g

• Design and specification are subject to change without notice.